

TRESHOLD FOR HST

HST10 /HST20



ZERO-THRESHOLD
for sliding doors



KEY ADVANTAGES:

- Completely flat thresholds
- Suitable for plastic and wooden lift-and-slide doors
- High thermal parameters, suitable for passive houses
- Wide selection of additional elements, such as transition profiles, linear drains, and mats
- Applicable in both new construction and renovation projects
- Option to choose renovation thresholds: HST10 and HST10/1 – SHORT
- Impeccable design crafted from high-quality materials
- Delivered ready for installation
- Stock lengths ranging from 2500 to 6500 mm (renovation thresholds HST10/1-SHORT max length 6000 mm)
- Compatibility with various types of fittings for HST



YEARS OF
EXTENSIVE
experience in
threshold
technology

TESTED QUALITIES

- Water tightness up to class E750
- Air permeability class 4
- Wind load class C2

Tests conducted at the IFT Rosenheim laboratory.
(The results were obtained with the Salamander eDrive HST system.)



Test results for thresholds are
available at www.alumaster.pl



COMFORT AND SAFETY

Zero-threshold systems for sliding doors are used in modern residential buildings (houses, residences), public facilities (hospitals, nurseries, schools, care homes), and commercial establishments (hotels, guesthouses, restaurants).

Exceptional thermal properties enable their use in passive construction as well. These features make zero-threshold systems a perfect fit for the demands of discerning customers.

THRESHOLD COMPLIANT WITH DIN18040 NORM

COMPATIBLE WITH SYSTEMS:

- Salamander
- Gealan
- Profine
- Rehau
- Veka
- Schüco
- Aluplast
- Inoutic – Wooden Profiles

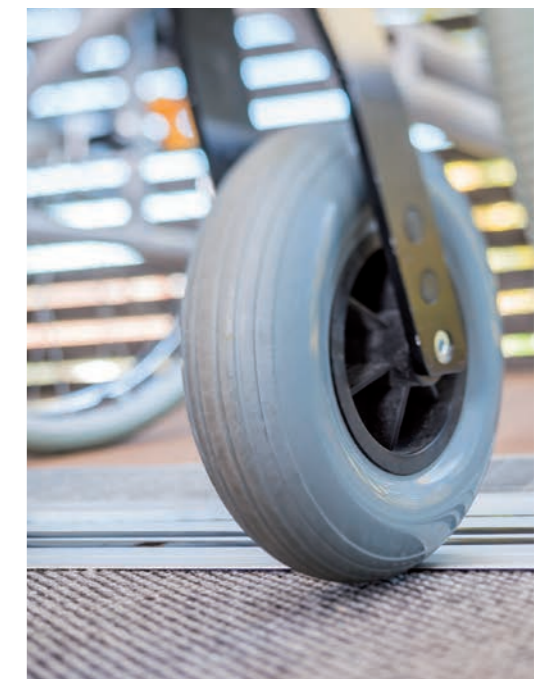

ADDITIONAL SYSTEM ELEMENTS:

TRANSITION PROFILE

- e.g. for connections with terraces.

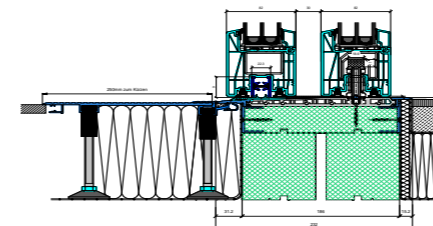

DRAINAGE PROFILE:

- Customized solution for water drainage.

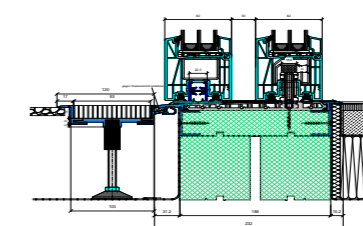

MAT:

- Aesthetic and functional finishing.

